

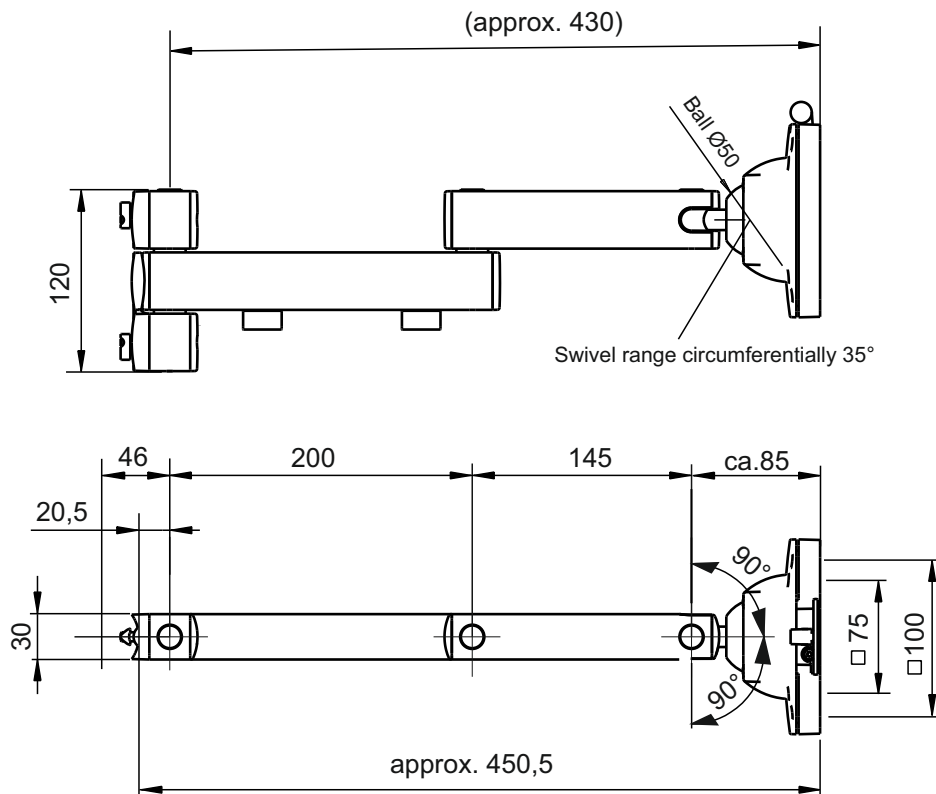

Monitor folding arm



Ref.:	509203		
Width (mm):	100		
Depth (mm):	450		
Height (mm):	120		
Net weight (kg):	1.70		

Description:
Monitor folding arm

for flexible attachment of a monitor in the system grooves of Rocholz profiles with perforation, on support column (509001,509002, 509006), on profile rail (509005) or upright adapter (509003), incl. cable holder

- VESA 75/100 quick-release attachment
- Load capacity 10 kg



Monitor folding arm

Ref.:	509203			
Number of packets:	1			
EAN:	4030177031886			
Size WxDxH (mm):	260x320x130			
Weight (kg):	2.00			

Examples:
Optional accessories



Keyboard and mouse platform with folding arm
Ref.:509201



Monitor support carriage
Ref.: 509202



Monitor folding arm
Ref.: 509204



Support column with screw clamp
Ref.: 509002



Profile rail for folding arms for IT
Ref.: 509005

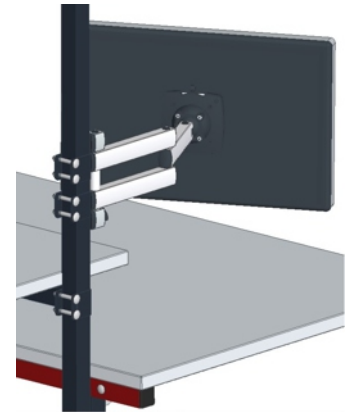

Upright adapter for attaching 509201, 509202, 509203
Ref.: 509003

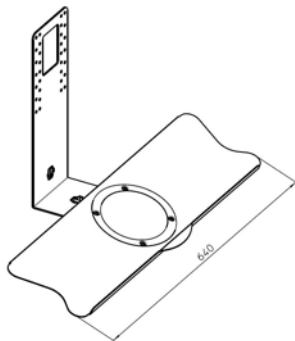

Keyboard adapter for mounting at screen folding arm
Ref.: 509205

Upright adapter for attaching 509204, 509207, 509209
Ref.: 509004

All information / dimensions approx., techn. information subject to change • as of: 01/2025